

YORK TOWNSHIP SECTION 27 R 13 TWP 10 MORGAN COUNTY, OHIO

PIN	Owner	LegalDescr	Acres	VOL	PAGE	Survey_Ref
190-000-960-0	BARKMAN CLEMENT AND MIC	R13 T10 S27 SD 18	1.55	OR223	3192	YRK-0175.pdf
190-000-950-0	BARKMAN CLEMENT AND MIC	R13 T10 S27 SD 12	0.53	OR223	3192	YRK-0175.pdf
190-000-940-0	BARKMAN CLEMENT AND MIC	R13 T10 S27 SD 3	0.62	OR223	3192	YRK-0175.pdf
190-000-280-0	BARKMAN CLEMENT DALE	R13 T10 S27 SD 9-10	157.44	OR218	1541	NoSurvey.pdf
190-000-300-0	BARKMAN MARTIN JAY & CLE	R13 T10 S27 SD 7	40.19	OR200	511	NoSurvey.pdf
190-600-080-0	CHURCH (DUTCH HILL LUTH)	R13 T00 S27 0	1			NoSurvey.pdf
190-600-090-0	CHURCH (DUTCH HILL LUTH)	R13 T10 S30 LOT 3	2			NoSurvey.pdf
190-003-530-0	CLA-RAY CIRCLE BAR HOME	R13 T10 S27 SD 19	1.211	OR223	3189	YRK-0058.pdf
190-002-830-0	CLA-RAY CIRCLE BAR HOME	R13 T10 S27 SD 8	0.5	OR223	3184	NoSurvey.pdf
190-002-820-0	CLA-RAY CIRCLE BAR HOME	R13 T10 S27 SD 6	56.24	OR223	3184	NoSurvey.pdf
190-002-810-0	CLA-RAY CIRCLE BAR HOME	R13 T10 S27 SD 16	74.36	OR223	3184	NoSurvey.pdf
190-002-130-0	GARRETT VAUGHN K & KIMBE	R13 T10 S27 SD 1 SUR	81.48	OR26	341	NoSurvey.pdf
190-002-120-0	GARRETT VAUGHN K & KIMBE	R13 T10 S27 SD 2 SUR	40.17	OR26	341	NoSurvey.pdf
190-003-720-0	GOLDSMITH RICHARD L & CA	R13 T10 S27 SD 14	39.65	OR224	67	NoSurvey.pdf
190-003-710-0	GOLDSMITH RICHARD L & CA	R13 T10 S27 SD 15	23.76	OR224	67	NoSurvey.pdf
190-002-590-0	HILL VELMA	R13 T10 S27 SD 11	39.21	OR219	3106	NoSurvey.pdf
190-003-530-1	LAPE TIMOTHY E & MELINDA	R13 T10 S27 SD 4 SUR	2.079	OR229	1672	NoSurvey.pdf
190-002-660-0	LAPE TIMOTHY E & MELINDA	R13 T10 S27 SD 13 SUR	1.65	OR229	1672	NoSurvey.pdf
190-002-670-0	LAPP MATTHIAS & ROSEMARY	R13 T10 S27 SD 17	2.04	OR233	735	YRK-0033.pdf
190-002-800-0	MURPHY MICHAEL L & SUNDA	R13 T10 S27 SD 5 SUR	81.1	OR98	588	NoSurvey.pdf
190-600-270-0	TWP TRUSTEES EAST PRECIN	R13 T10 S27 LOT 6	0.25			NoSurvey.pdf

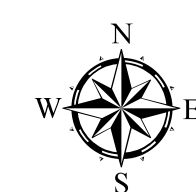

Boundaries			
	Hydro		Section
	Roads		Lot
	County		Township
	Parcel		ROW

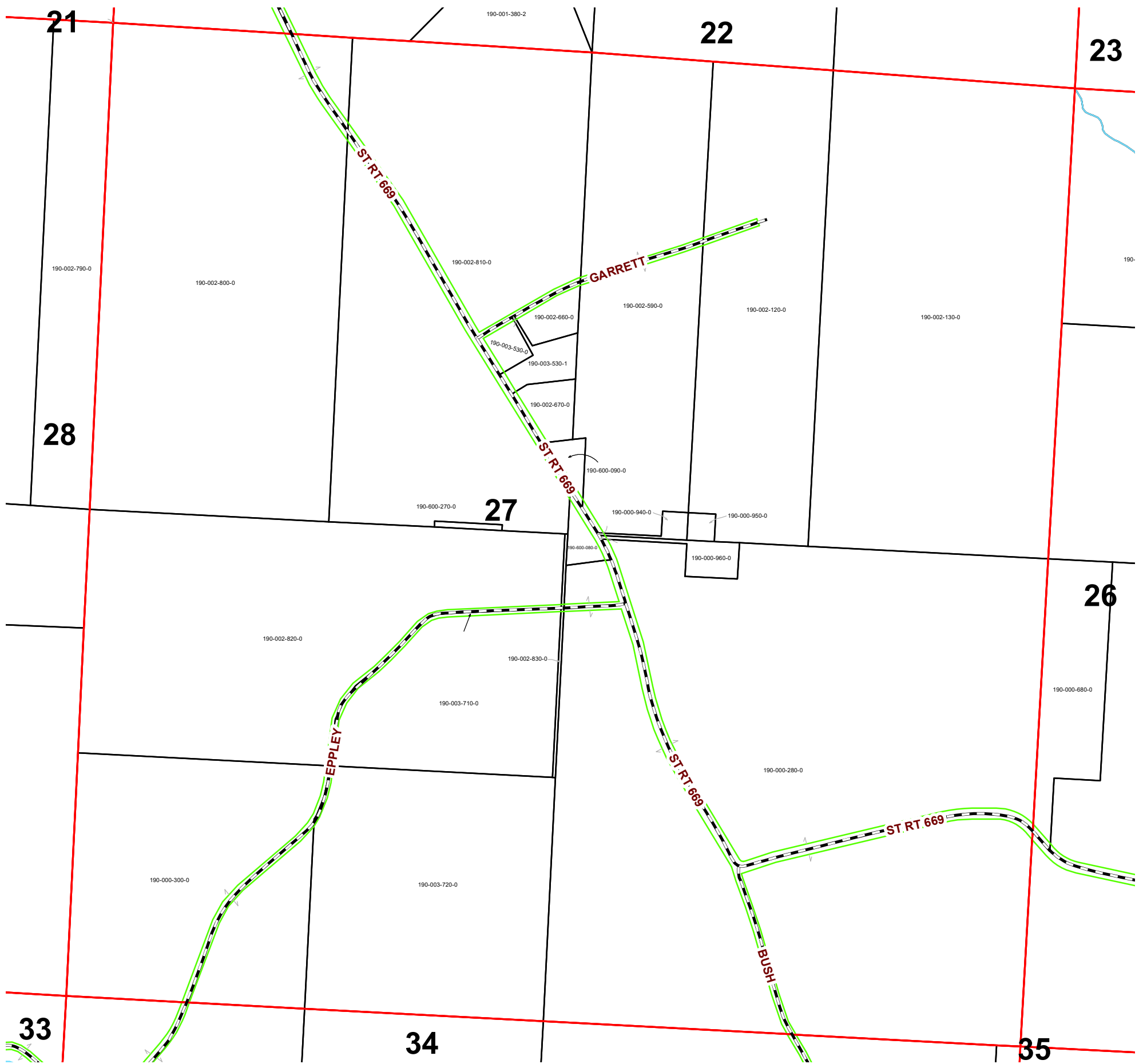
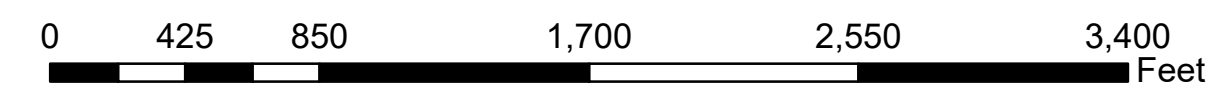

Source: Morgan County Engineer's Office
 Author: Marcia Wolfe
 Date: 02/10/20

Disclaimer: The information that these maps contains is for reference purposes only. Please bring any erros to the attention of the Engineer's Office staff. Thank you